



SOMAYAJI Green Wood

Commercial Complex & Residential Building
Landlinks, Konchady, Mangalore



Apartments Tailored to
Your Highest Standards.

www.somayajiestates.com

SOMAYAJI Green Wood



Somayaji Estates (P) Ltd has given to many prestigious residential and commercial projects in past few years by its excellence, which has helped the organization by providing amenities to represent a unique place among the leading builders of Mangaluru.

Presenting **Somayaji Greenwood** 1, 2, and 3 Bedroom apartment well planned and designed for Vasthu. All rooms are spacious. This is not only to provide for present needs but future requirements of the additional gadgets and home appliances.. Every apartment is designed keeping in mind the need for convenience and comfort of the families who choose **Somayaji Greenwood** as their home.

Another great thing about **Somayaji Greenwood** is the Location. It is nestled in Landlinks which has all civic conveniences like Shopping malls, fitness and healthcare center's, Educational Institutions and placed of worship within stone's throw. **Somayaji Greenwood** is centrally located between two main roads which connects international airport, the main airport road is just 1.2 K.M. and Kuntikana - Kavour airport road is just 350 mtrs. from the site.

Highlights

- ◆ Addressable fire fighting system
- ◆ Modular electrical switches & Wiring with superior quality wires.
- ◆ TWO ELEVATORS of 8 passenger capacity.
- ◆ GENERATOR for common and apartment lighting with sound proof enclosure.
- ◆ SECURITY ROOM.
- ◆ CAR PARKING in Basement floor (at extra cost).
- ◆ RETICULATED GAS CONNECTION.
- ◆ GRANITE FLOORING for the common areas and VITRIFIED TILES inside the apartment.
- ◆ INTERLOCK PAVING for car parking and yard.
- ◆ POWDER COATED ALUMINIUM SLIDING WINDOW
- ◆ ATTRACTIVE MELAMINE POLISHED DECORATIVE MAIN ENTRANCE DOOR.
- ◆ DESIGN GLAZED TILES for toilets and kitchen (24" above platform).
- ◆ GRANITE PLATFORM with GRANITE/ STAINLESS STEEL SINK for kitchen.
- ◆ CP PLUMBING FITTINGS for Bathroom/Toilets and kitchen.
- ◆ WHITE COLOURED SANITARY WARE (Hindustan / Jagwar) in all the Bathroom/Toilets and kitchen.
- ◆ Painting for ceiling and walls PUTTY FINISHED ACRYLIC DISTEMPER.
- ◆ Abundant open well in addition to CORPORATION Water Connection



Typical Floor Plan

2nd To 4th Floor Plan

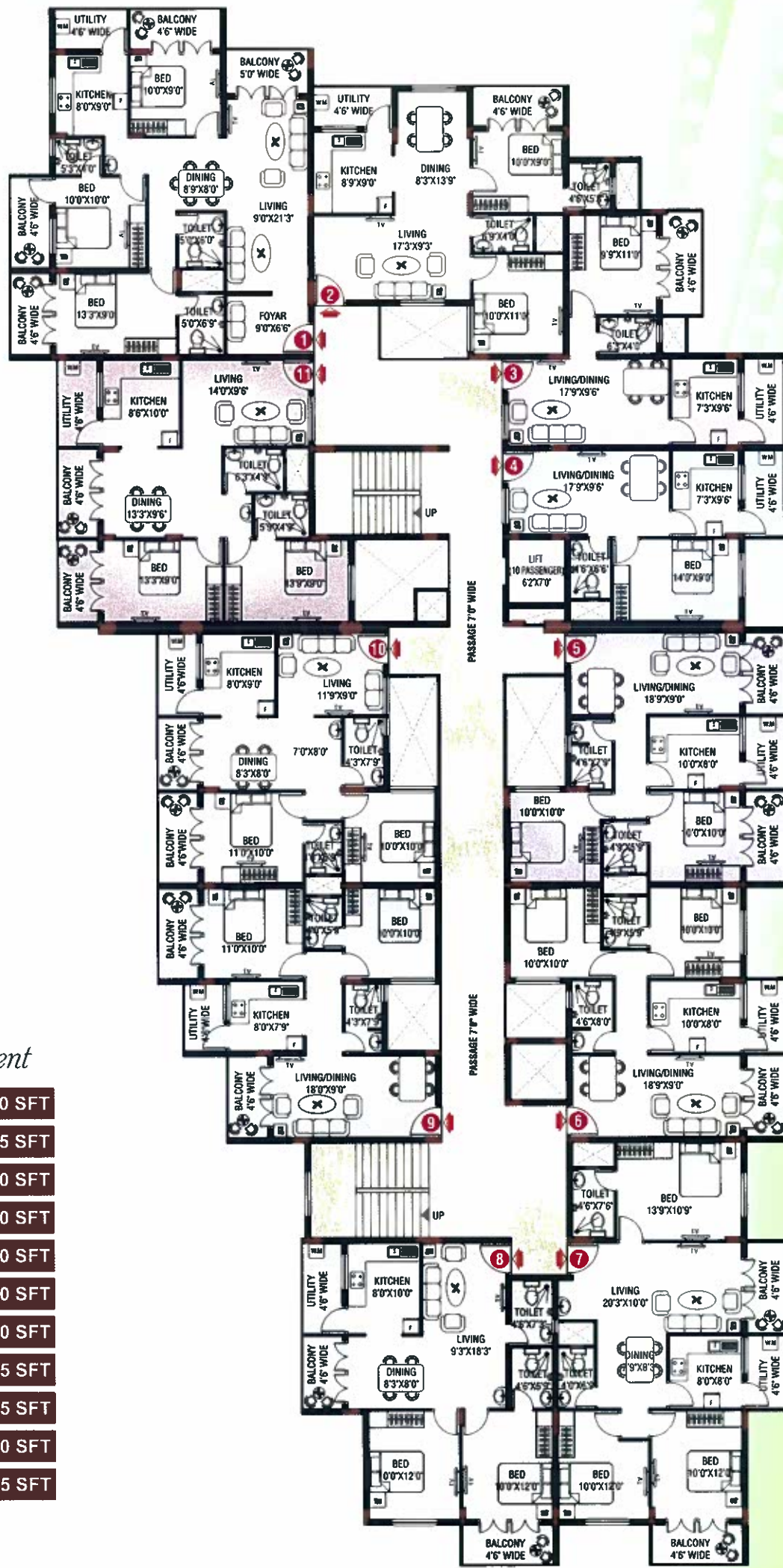
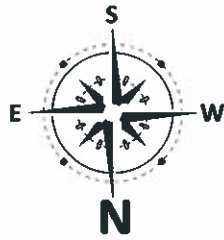

Area Statement

Flat No. 1(3 BED)	1380 SFT
Flat No. 2(2 BED)	915 SFT
Flat No. 3(1 BED)	640 SFT
Flat No. 4(1 BED)	590 SFT
Flat No. 5(2 BED)	890 SFT
Flat No. 6(2 BED)	830 SFT
Flat No. 7(3 BED)	1180 SFT
Flat No. 8(2 BED)	985 SFT
Flat No. 9(2 BED)	875 SFT
Flat No. 10(2 BED)	920 SFT
Flat No. 11(2 BED)	1025 SFT

Location Map

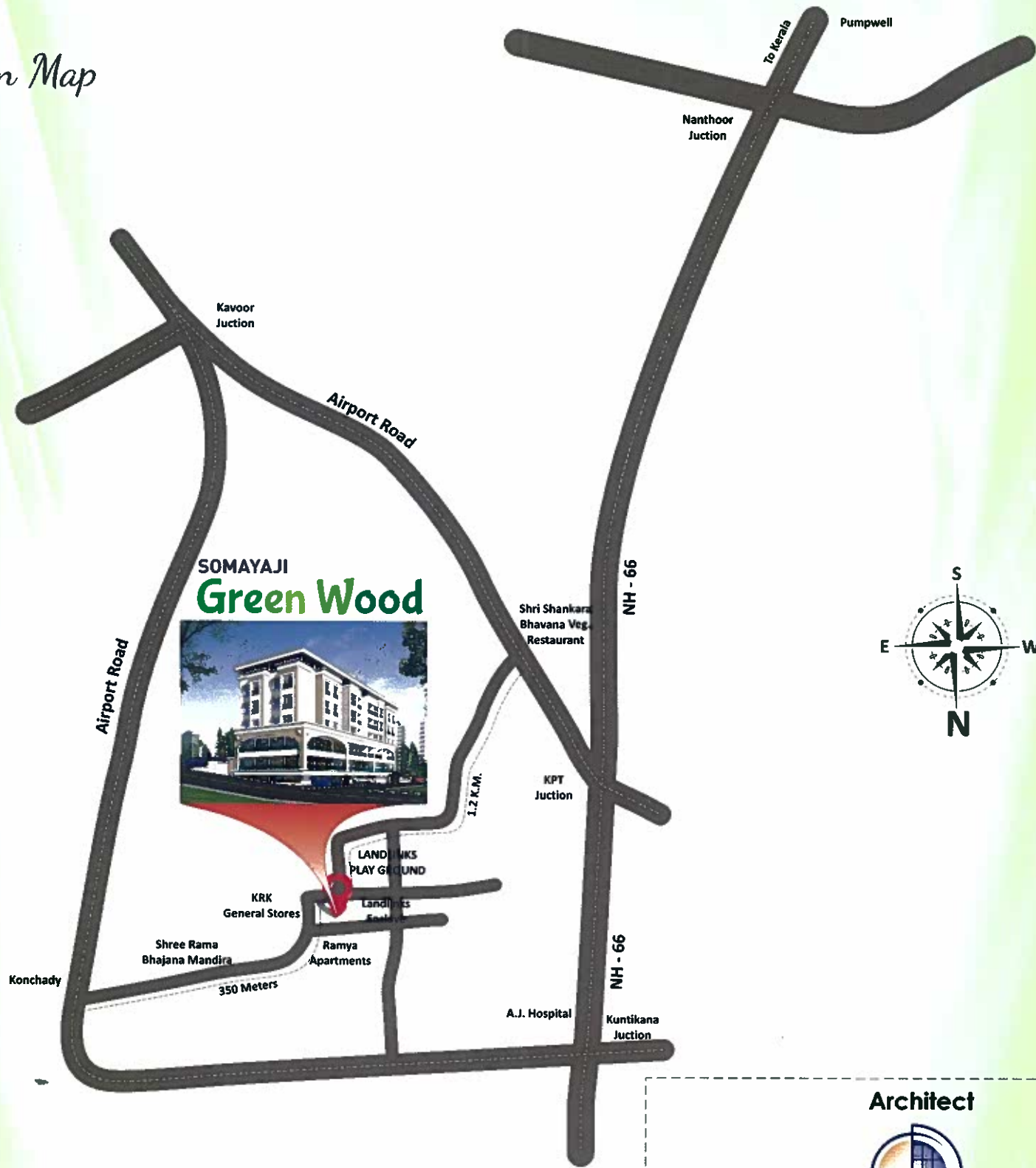

Promoter :
B. R. SOMAYAJI
SOMAYAJI ESTATE PVT LTD

Essel Towers, 6th Floor, Bunts Hostel Circle,
 Mangaluru, Karnataka, INDIA - 575 003

- ☎ +91 99723 64868, 99724 40868
- ✉ somayaji.estates@gmail.com
- 🌐 www.somayajiestates.com



Architect



EDGING PERFECTION

shenoy associates

architecture designers & valuers

No 19 & 20, IIIrd Floor, Manasa Towers,
 Kodialbail, Mangalore - 575 003
 E-mail : shenoy.associates@yahoo.co.in

Structural Consultant

H. Anand Bhat
Design Associates

Jyothi-Kiran Apartments,
 Microwave Statuion Road,
 Hat-Hill, Mangaluru - 575 006

This brochure is conceptual in nature and is by no means a legal offering. The promoters reserve the right to change, delete or add any specification or plan mentioned herein.